

INSTALLATION INSTRUCTIONS

for the Trolldtekt access panel
installed in the C60 profile system

Trolldtekt® 
Natural acoustic solutions

These instructions refer to installing the Trolldtekt access panel 300X300, 400X400 or 600X600 mm in a C60 profile system.

INSPECTION ON RECEIPT

Check that the following components are complete and undamaged on receipt. Please inform the supplier immediately of any visible defects or non-conformities as we are unable to accept claims regarding visible defects and non-conformities once the access panel has been fitted. Please also refer to the instructions regarding storage and acclimatisation as well as care and maintenance of Trolldtekt acoustic panels – download at www.trolldtekt.com

COMPONENTS

600X600 mm access panel

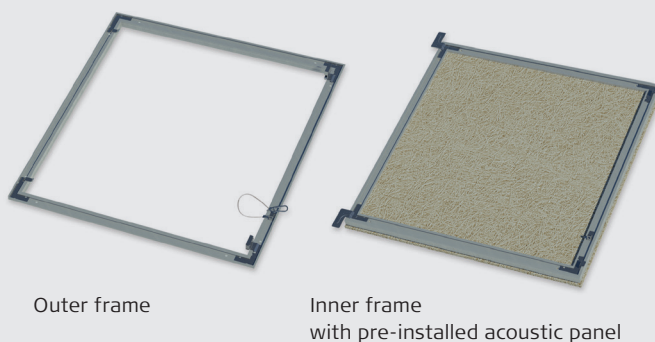

300X300 and 400X400 mm access panel

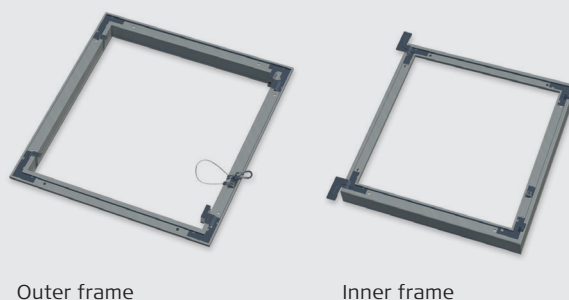

INSTALLATION DIAGRAM

600X600 mm access panel

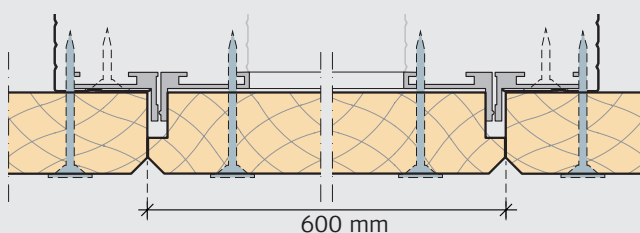

300X300 and 400X400 mm access panel

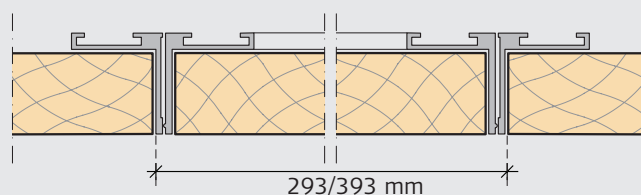

SEPARATING THE ACCESS PANEL PRIOR TO INSTALLATION

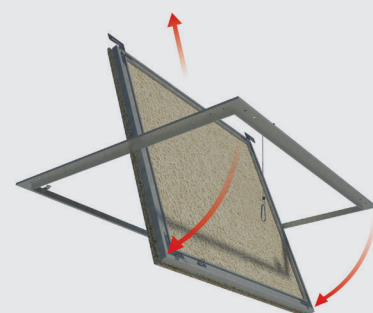
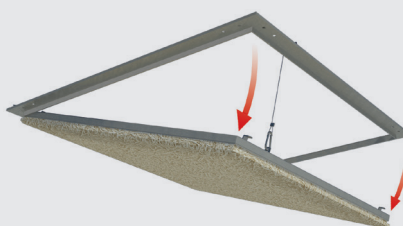

INSTALLATION OF 600X600 MM ACCESS PANEL

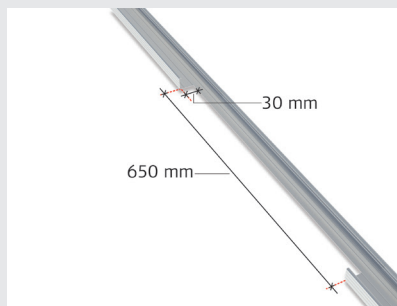

4: Make cuts as shown to enable installation in the two C60 profiles which will carry the access panel.

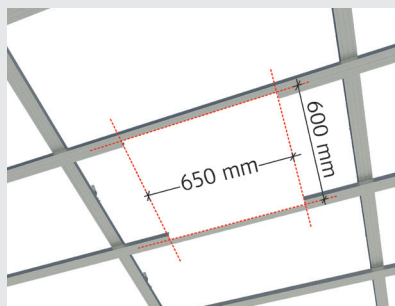

5: Profile system prepared for installation of the 600 mm access panel.

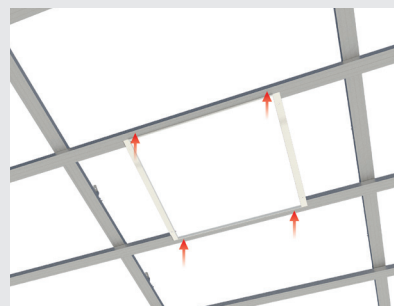

6: Hold the outer frame in position and secure it to the profiles with four self-drilling screws. Then replace the access panel inside the outer frame.

INSTALLATION OF 300X300 AND 400X400 MM ACCESS PANEL



1: Cut a hole for the outer frame, and apply assembly adhesive on the back of the panel.



2: Separate the outer frame from the inner frame (see illustration of the 600 mm access panel), and then press it down into the Troldekt® acoustic panel.

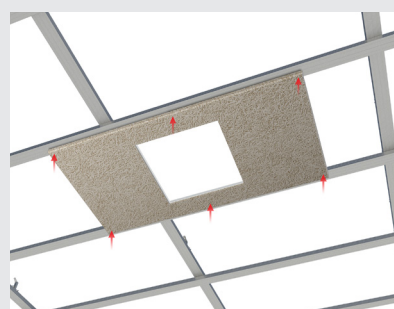

3: With the outer frame installed, now screw the acoustic panel in place in the C60 profile system.

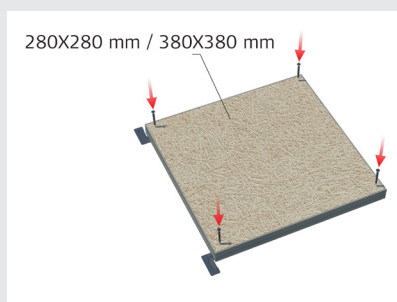

4: Cut out a section of acoustic panel for installing in the inner frame of the access panel. Secure the panel with four self-drilling screws. The access panel can now be put into place.

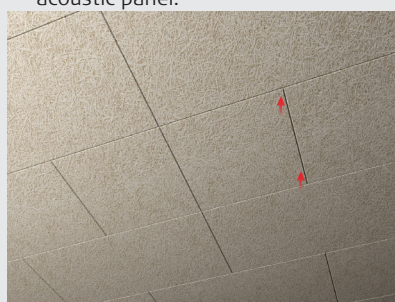

A: To open the access panel, press the Troldekt acoustic panel lightly under the push release locks.

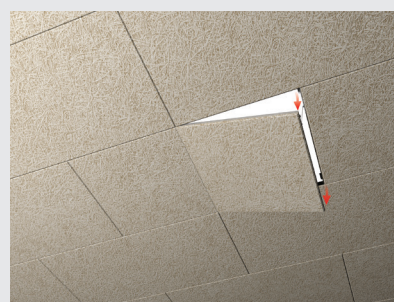

B: Release the snap hook to open the access panel completely.

FURTHER INFORMATION

At www.troldekt.com you can always download the most recent version of these installation instructions; here, you will also find the complete range of Troldekt installation instructions, including installation instructions for the C60 profile system as well as instructions for installing Troldekt acoustic panels with screws.